



बैंक नोट पेपर मिल इण्डिया प्रा. लिमिटेड
BANK NOTE PAPER MILL INDIA PVT LIMITED
JV of SPMCIL - A Govt. of India Enterprises & BRBNMPL - A Subsidiary of RBI

BANK NOTE PAPER MILL INDIA PRIVATE LIMITED
CIN: U21090KA2010PTC055475 | CORPORATE OFFICE, MYSORE
Scmcommon@bnpmindia.com
Ph: 0821 2401 178

Enquiry No: BNPM/OTE/Mechanical Seals/0480/2022-23

Issuing date: 05.10.2022; 1500 Hrs.
Closing date: 11.10.2022; 1500 Hrs.

1. Scope of Supply: Supply of following items

S No	Item Description	UoM	Quantity
1	Bellow type mechanical Seal for MONO pumps ,Model C2XA Size 32MM <ul style="list-style-type: none">Pump Model :- C2XA (Handling H2O2) – Highly AcidicMechanical Seal :- M032139G (Bellow type)Shaft Dia :- 32MMMoc of bellow material :- VITON/ Equivalent	No's	2
2	Mechanical Seal;Type: rubber bellow; Shaft Dia: 30mm; Length: 40mm; faces : Carbon v/s Ceramic Dynamic part length: 30mm; Stationary Part Length: 10 mm	No's	3

2. Terms & Conditions:

S. No	Particulars	Quantity
1.	Payment Terms	100% within 30 days from date of receipt and acceptance of goods by the consignee at destination and on production of all required documents by the supplier.
2.	Price	Price should be inclusive of all taxes & duties.
3.	Freight	Shall be included in quoted price.
4.	Packing & Forwarding	Shall be included in quoted price.
5.	Delivery Terms	F.O.R – Bank Note Paper Mill India Private Limited, Mysore.
6.	Warranty Period	12 months from date of supply at BNPM, Mysuru.
7.	Warranty Certificate	Applicable / Not Applicable
8.	Delivery Period Weeks from date of receipt of purchase order.

9.	Liquidated damages	Liquidated damages shall be applicable at the rate of 0.5% per week or part thereof until actual delivery or performance, subject to a maximum deduction of 10% of the delayed good's /service's contract price.
9.	Validity of Bid	30 days from date of closing of tender.
10.	Material to be delivered at	Engineering Stores, Bank Note Paper Mill India Private Limited, Note Mudran Nagar, Mysore 570 003.
11.	Contact person	Mr. Saideep. N P: 0821-2401178

Setting Length - Mechanical Seal

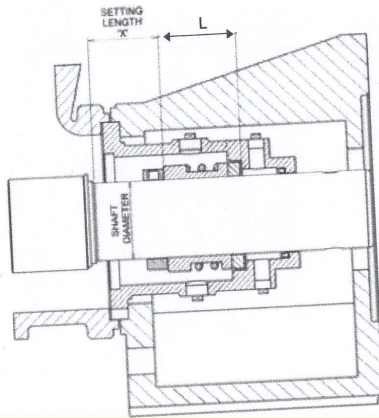

Pump Size	Drive Type	Shaft Diameter mm	Seal Part No.	Seal Working Length L mm	Setting Distance 'X' mm
C22D C23A C23B C23K C2XA C2XB C1XK	Pin Joint	32	M032139G	42.5	16
C13D C14A C14B C14K C15A C15K	Pin Joint	45	M045139G	45.0	41
C1XD C14D C15B C16A C16K	Pin Joint	55	M055139G	47.5	34.5
C15D C16B C17A C17B C17K C18A C18K	Pin Joint	65	M065139G	52.5	33.5

NOTE: All seal working lengths are to DIN L1K dimensions.
 This table is not to be used for standard or DIN L1N working length seals.
 All seals use 'M' type seat except for 85mm which uses 'BS' type or 'M' type.
 This table is not necessarily compatible with any other seal type - check with Mono Pumps Technical Dept.

Section 4, Page 42
 Issued - April 2009

Mono[®] NOV
 One Company, Unlimited Solutions

Price Bid Format:

S No	Description	Qty	UOM	Unit rate	Freight, P&F Charges	GST @	Unit rate including GST & Freight, P&F Charges	Grand total inclusive of GST and Freight, P&F Charges (F.O.R, BNPM, Mysore)
1	<p>Bellow type mechanical Seal for MONO pumps ,Model C2XA Size 32MM</p> <ul style="list-style-type: none"> • Pump Model :- C2XA (Handling H2O2) – Highly Acidic • Mechanical Seal :- M032139G (Bellow type) • Shaft Dia :- 32MM • Moc of bellow material :- VITON/ Equivalent 	No's	2					
2	<p>Mechanical Seal;Type: rubber bellow; Shaft Dia: 30mm; Length: 40mm; faces : Carbon v/s Ceramic Dynamic part length: 30mm; Stationary Part Length: 10 mm</p>	No's	3					
Total price inclusive of all tax, freight , P&F & any other charges								

Note: Evaluation shall be carried out based on item wise L1 price.

HSN Code: (_____)

We hereby confirm that

1. We accept all terms & conditions mentioned in the enquiry.
2. Price quoted is inclusive of all taxes, P&F, freight etc. on F.O.R, BNPM, Mysore basis.

Signature of bidder:.....

Name of the Firm:.....

Seal of the firm:

GST No:

Note: Interested bidders are recommended to register themselves at company's website <https://bnpmindia.com/Vendor.aspx> in order to get future enquiries of relevant items